

# iColor 650 Set UP

1. Open the outer box and removed the Black toner and drum package



2. Open and remove the packaging, power cord, ProRIP software from the box



3. Remove outer packaging, remove printer from lower part of the box, and place on desk
4. After removing the bag from around the printer, set aside all documents.



5. Follow the directions to open the printer and remove the packaging around the toner and drums



6. The white toner and drum are in the black bag inside the printer



7. The toner and drum assembly tone unlocked from each other.
8. Be sure to set the toner and drums on a table before removing the packaging





- a. Make sure that you lock the toner to the drum assembly before picking them back up and putting back in the printer

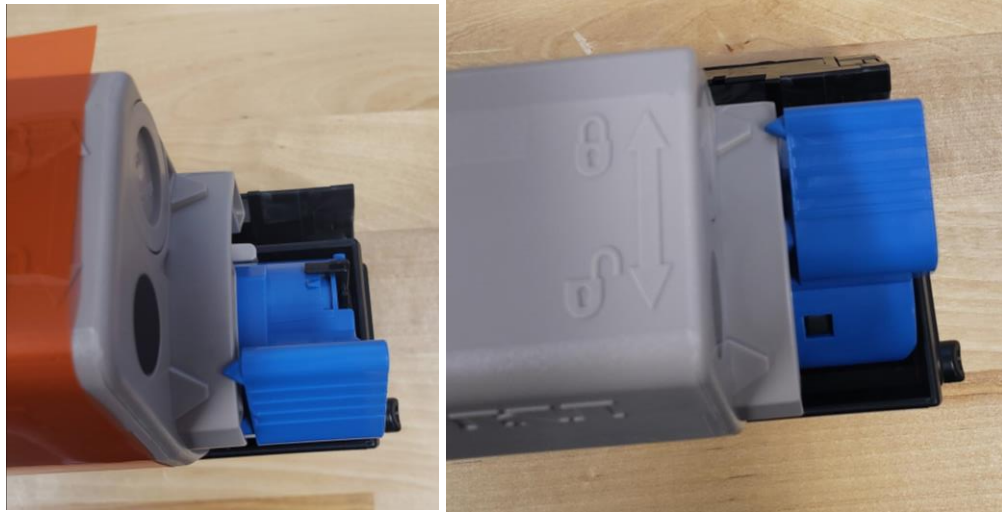

9. Once you have all the toner and drums ready and back in the printer, this is how it should look



10. Now you can finish the install and set up process by following the directions that are on the laminated paper that came in the box that was with the other documents after removing the printer from the box.